

# Hello!

.Artproof.  
**BOX**

## You have received an Artproof BOX

Here you can find a simple instruction how to pack your art product for safe transport

### How to **BOX**?

#### 1 Open the BOX

There you'll find protective padding.  
Remove the top pieces to make way for art.

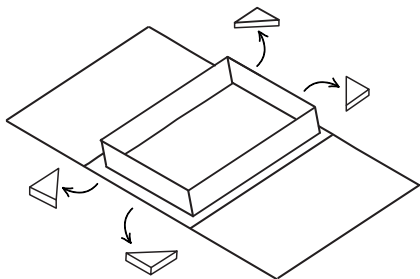

#### 2 Place art in the BOX

Always make sure that your art piece is firmly set in place and does not move around.

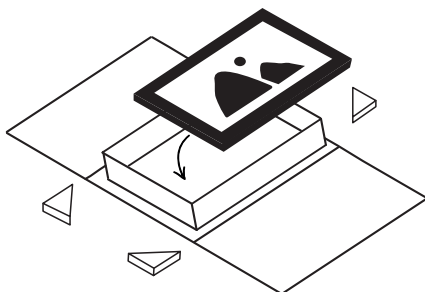

#### 3 Close the BOX.

Put the protective pieces back in their place and close the BOX.

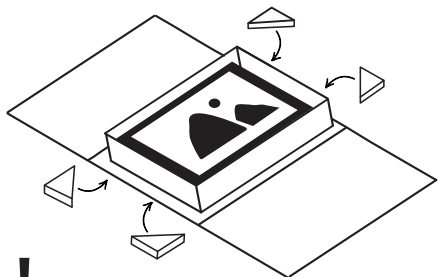

!

If the image is not protected with glass or other protective material, we recommend placing another soft layer (for example rice paper) on the surface of the image for protection, so that the cushions in the box do not scratch the surface of the image.

!

On the back of the BOX you will find a white surface that acts a canvas for you to illustrate or brand anyway you like. Do this to make this BOX truly yours.

#### 4 Seal it and send it.

Seal the box by threading the rope through the holes in the lid. Wrap it around the button on the side and seal it with a sticker.

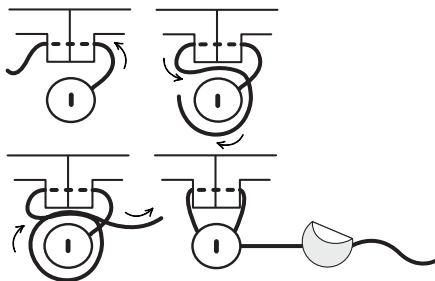

# How to **un**-BOX?

Artproof BOX is made from recyclable honeycomb cardboard and can be easily disposed of. Here you can find a simple guide on how to do it.

## 1 Take apart

After removing your art piece from the box, take out all the loose parts.

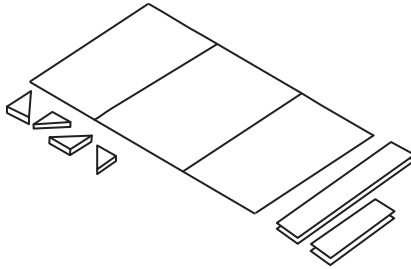

## 2 Cut to pieces

Cut the cardboard into smaller pieces using a blade cutter.

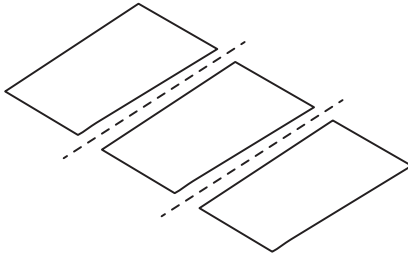

## 3 Throw away.

After cutting the box into smaller pieces you can throw it in the nearest cardboard recycling bin. All the plastic padding can be thrown into a plastic recycling bin.

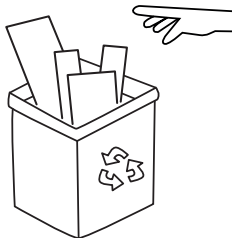

Send **art**.  
Not crates.

#artproof